

Suspension Anchor

Head Style: Tie Wire
Material: Carbon Steel
Class Grade: Low Tensile Class 5.8
Material Finish: Zinc Yellow Plated
Corrosion Protection Level: Moderate
Internal External: Internal

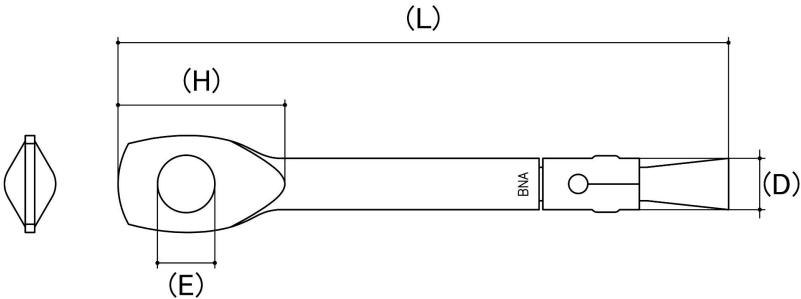

Cad Drawings shown for graphic representation only.*

Size	Length (L) (mm)	Head Height (H) (mm)	Eyelet Diameter (E) (mm)	Embedment Depth (mm)	Minimum Spacing (mm)	Drill Hole Depth (mm)	Drill Hole Size (mm)	sku (Part Number)
M6	60	14.00	6	30	90	45	6	65TWSA660

Disclaimer:
Dimensional data and technical information was obtained from publically available sources and not acquired through standard agencies. It has been completed and compiled for reference purposes only; where discrepancies are found they are subject to change without notice. Bolt & Nut Australia makes no warranties or representations regarding the accuracy and validity of the compiled information and data. Contact the relevant standard authorities for accurate and detailed information.
* Cad Drawings may not reflect diameter, thread length or overall length.